



CR1016EX is a 16U executive credenza with traditional furniture design. The elegant laminate finish is enhanced by the beveled door and precision European hardware. Can be butted together to span a room or wall.

Standard Features

- Thermowrap surf(x) finish
- Locking front and rear doors
- **RR16** 16U front and rear rack rails
- **FAN** Quiet cooling fan
- 4" heavy duty casters (2 locking)
- Can be butted together to span a room or wall
- Ships assembled

Options

- **MM1232** Monitor and camera mount (12" - 32")
- **PM2-S** Single monitor mount (37"-60" – 200 lbs max)
- **PB** Six outlet power bar with 10 ft. cord
- **TVCB** Camera bracket for freestanding or wall mount TV's
- **CS** Wall mount camera or codec shelf
- **FAN** Additional quiet cooling fan
- **9107** Lacing bar (19" long)
- **9031** Vented metal shelf
- **9041** Sliding shelf
- **9052** Sliding drawer
- **MAGKEY** Additional key for hidden locks
- **LEV4AX4** 4x Levelers for non-mobile applications

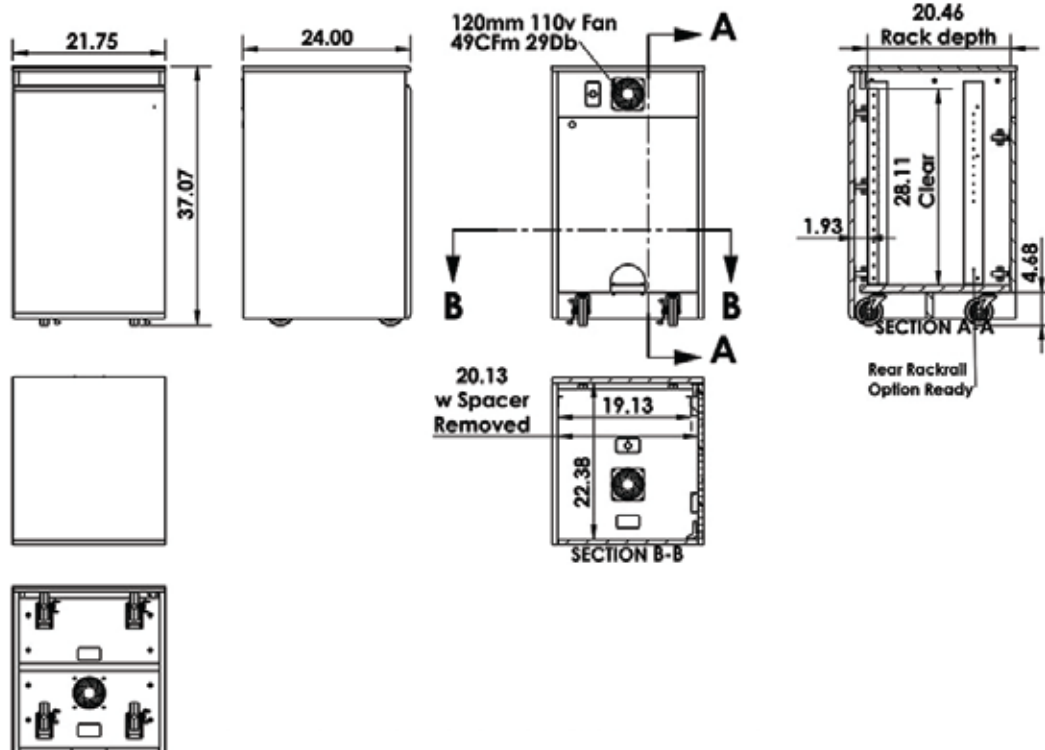

Side by side with CR3000EX (Sold separately)
(70" TV shown)

Specifications

Model: CR1016EX

Width: 21"

Depth: 24"

Height: 37"

Note: Usable rack depth - 20"

Finishes



Other finishes are available. Check website.

The information contained in this drawing is the sole property of Audio Visual Furniture International. Any reproduction in part or as a whole without the written permission of Audio Visual Furniture International is prohibited. AVFI can build or modify stock configurations to suit customer specifications. Please contact us to discuss how this service can help meet your needs. Some quantity restrictions may apply. Specification subject to change without notice. Computers, cameras, monitors, etc. are shown to illustrate product usage and are not included unless otherwise noted.